

Width of door (DW)	Width of window	Height of window
$876 \leq DW < 940$	340	640
$940 \leq DW < 1240$	640	
$1240 \leq DW \leq 1676$	940	

Width of window	Height of window
200	700

	Single door	Double door
Effective Opening width (AW)	$700 \leq AW \leq 1500$	$1400 \leq AW \leq 3000$
Opening height (H)	$1800 \leq H \leq 2500$	

10	Opening frame	-	
9	Gasket	E P D M	-
8	Guide roller	Stainless•Polyacetal	-
7	Door head rubber cushion	PVC extruded (PVC resin)	-
6	Grip	Stainless	25φ L=450
5	Rail cover	Colored steel plate	t=0.8mm color:Ivory
4	Rail	Unit of automatic closing system, etc	-
3	Window frame	Aluminum alloy extruded material	color:almite silver
2	Window	Acrylic plate	t=5.0mm color:Transparent
1	Suface material	Colored steel plate	t=0.6mm color:Ivory
No.	Name	Material	Remark

[illegible][illegible][illegible]

B-B' Section

Back plate, St-2.3t,
for reinforcement
of rail installation
L=length as the rail
(prepared by customers)

Thickness of wall

Truss tapping screw

Width of frame

3-sided-frame
Steel-1.6t Anticorrosive

Width of frame for
the door head

Aluminum, 1.6t

Plate rubber (black), 0.5t

Screw anchor 8-35

▽ FL±0

C-C' Section

Drawing No. BSDWT01100

Thickness of wall

Height of Back plate for reinforcement (H+30)

株式会社 不二物

Scale
1/2
/

Drawing No. -
Date - . - .

*19.11.20

Width of door (D W)	Width of window	Height of window
$876 \leq DW < 940$	3 4 0	6 4 0
$940 \leq DW < 1240$	6 4 0	
$1240 \leq DW \leq 1676$	9 4 0	

Long window (outer dimension)

Width of window	Height of window
200	700

*Maximum window dimensions: Within the area for window installation and not more than 50% of the area of the door (excluding the case when the door is made of glass)

	Single door	Double door
Effective Opening width (A W)	$700 \leq A W \leq 1500$	$1400 \leq A W \leq 3000$
Opening height (H)	$1800 \leq H \leq 2500$	

*When installing a lock, it will be installed only within the door end frame face width dimension (30 mm).

Opening frame for door installation (3-sided-frame) • Back plate for reinforcement should be prepared by customers.

10	Opening frame	-	
9	Gasket	E P D M	-
8	Guide roller	Stainless•Polyacetal	-
7	Door head rubber cushion	PVC extruded (PVC resin)	-
6	Grip	Stainless	25φ L=450
5	Rail cover	Colored steel plate	t=0.8mm color:Ivory
4	Rail	Unit of automatic closing system, etc	-
3	Window frame	Aluminum alloy extruded material	color:almite silver
2	Window	Acrylic plate	t=5.0mm color:Transparent
1	Suface material	Colored steel plate	t=0.6mm color:Ivory
No.	Name	Material	Remark

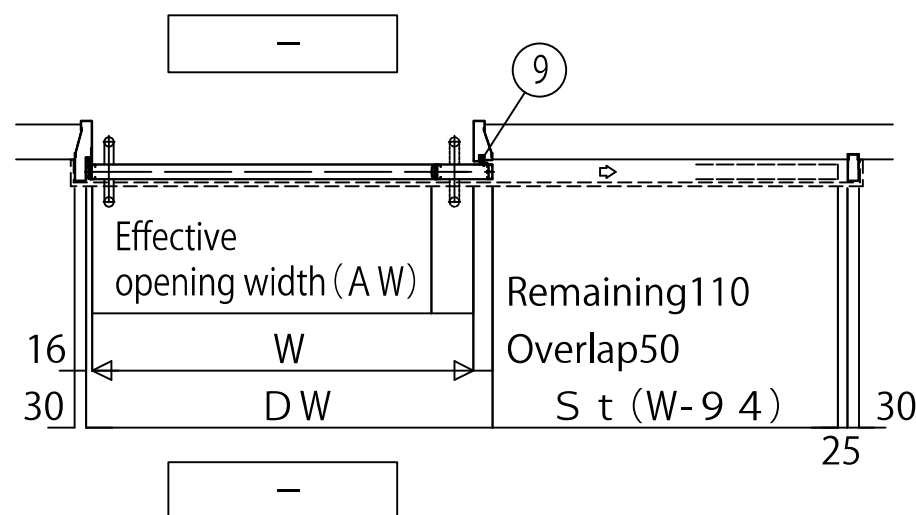
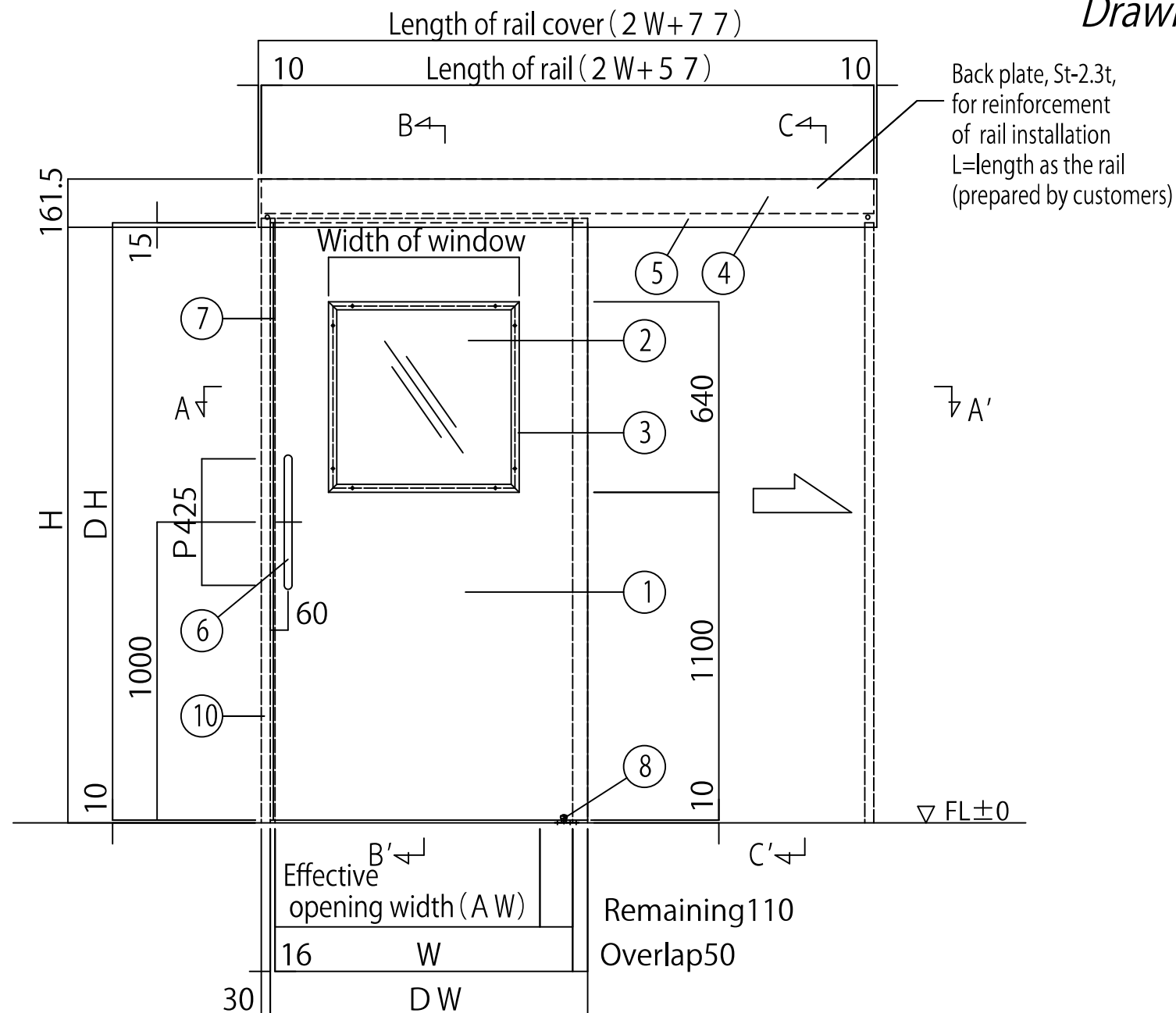

Code	Volume	Where to install
	-	~
Type	SLIDE DOOR S A T (Right) type	

-	o	-	o	-				Drawing Name						Scale	
	o		o					UNIFLOW SLIDE DOOR SAT(Right)		-	-	-	1/20	Drawing No.	-
	o		o					Image of basic installation					/	Date	- o - o -

When installing a door edge frame (optional)

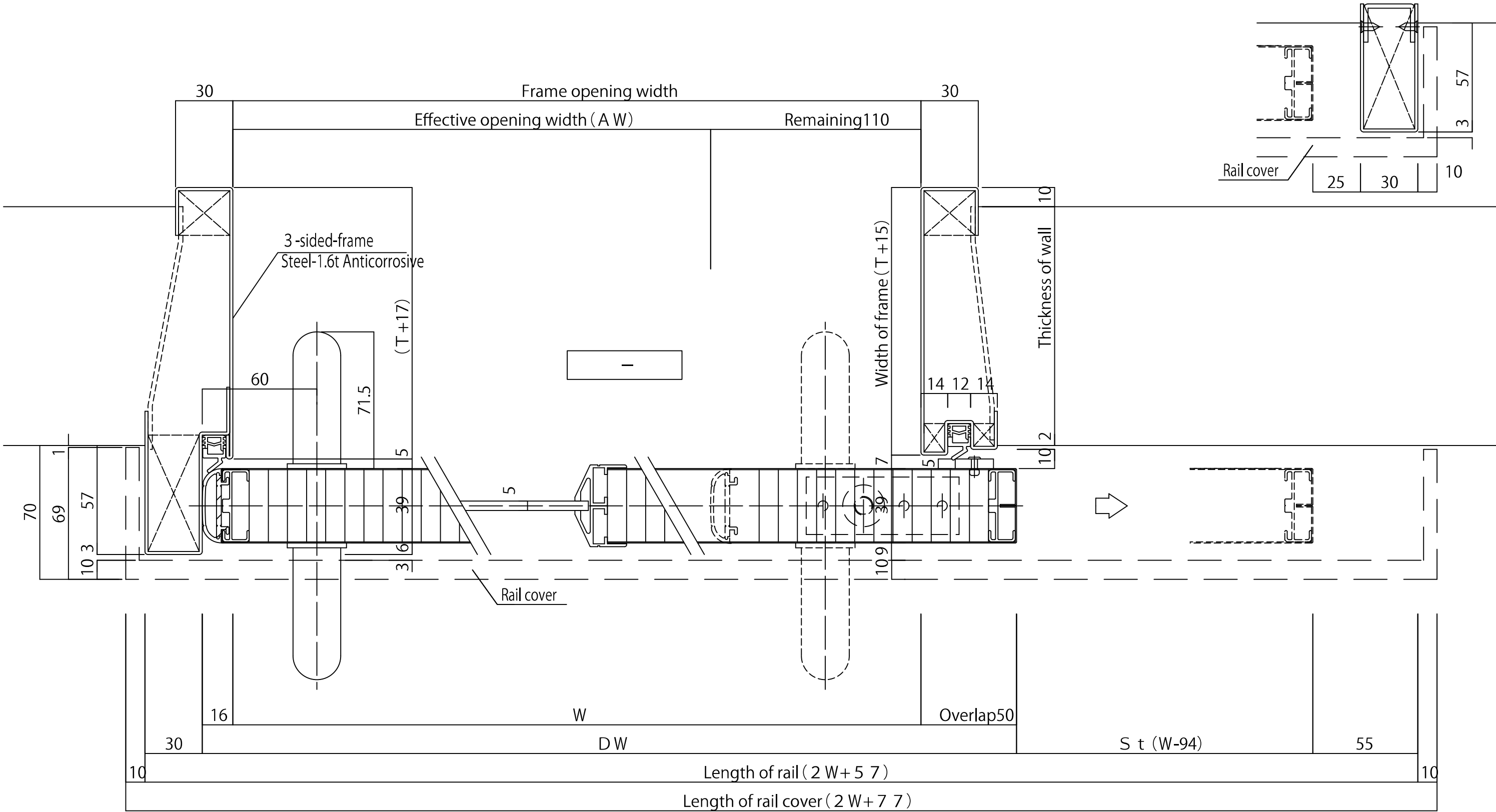

A-A' Section

<div><div></div><div></div><div></div><div></div><div></div></div>	-			Drawing Name	UNIFLOW SLIDE DOOR SAT(Right) Horizontal cross section					Scale	-
	-										Drawing No.
	-										Date
	-										- . - . -

B-B' Section

Back plate, St-2.3t,
for reinforcement
of rail installation
L=length as the rail
(prepared by customers)

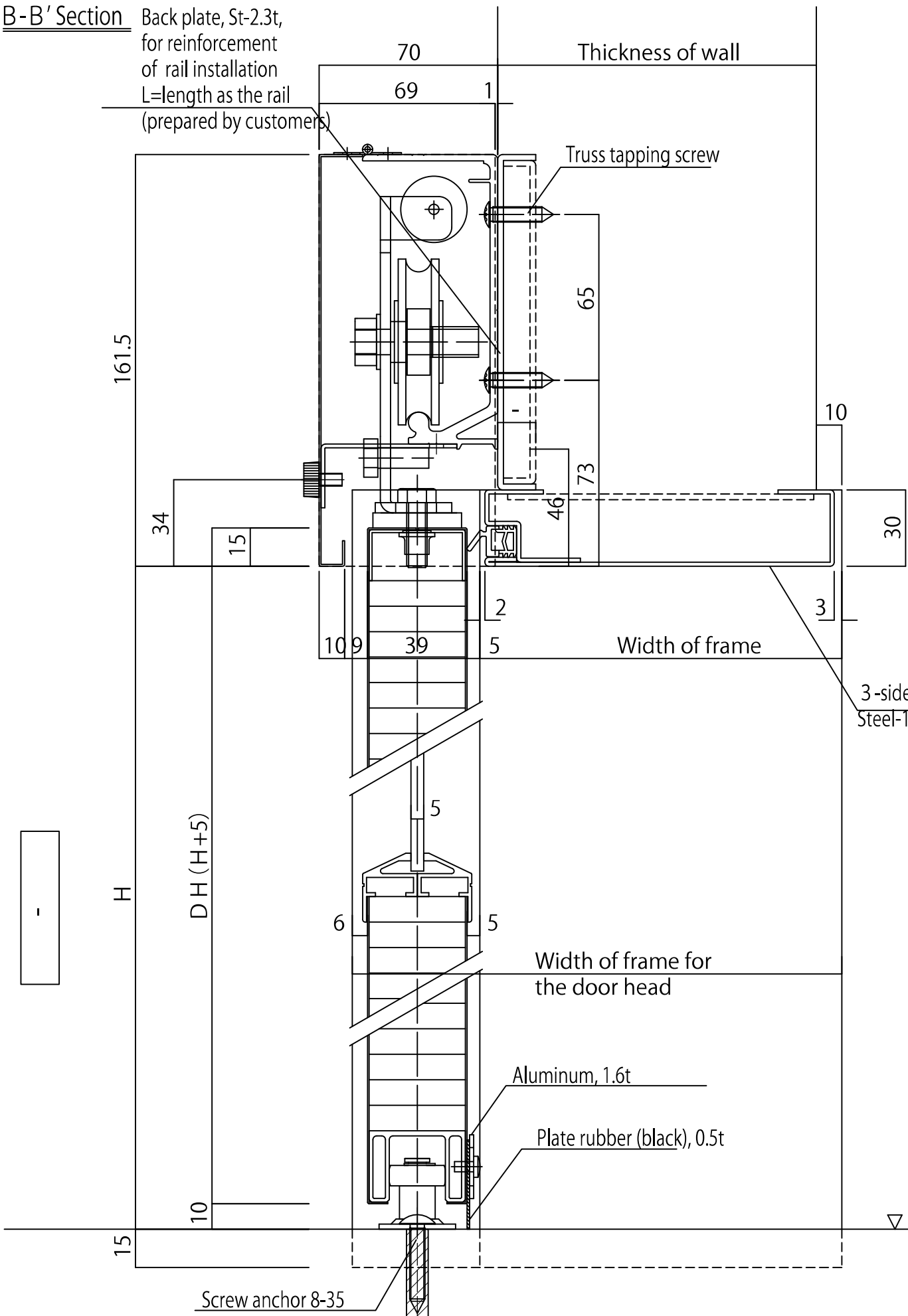

C-C' Section

Drawing No. BSDWT01100

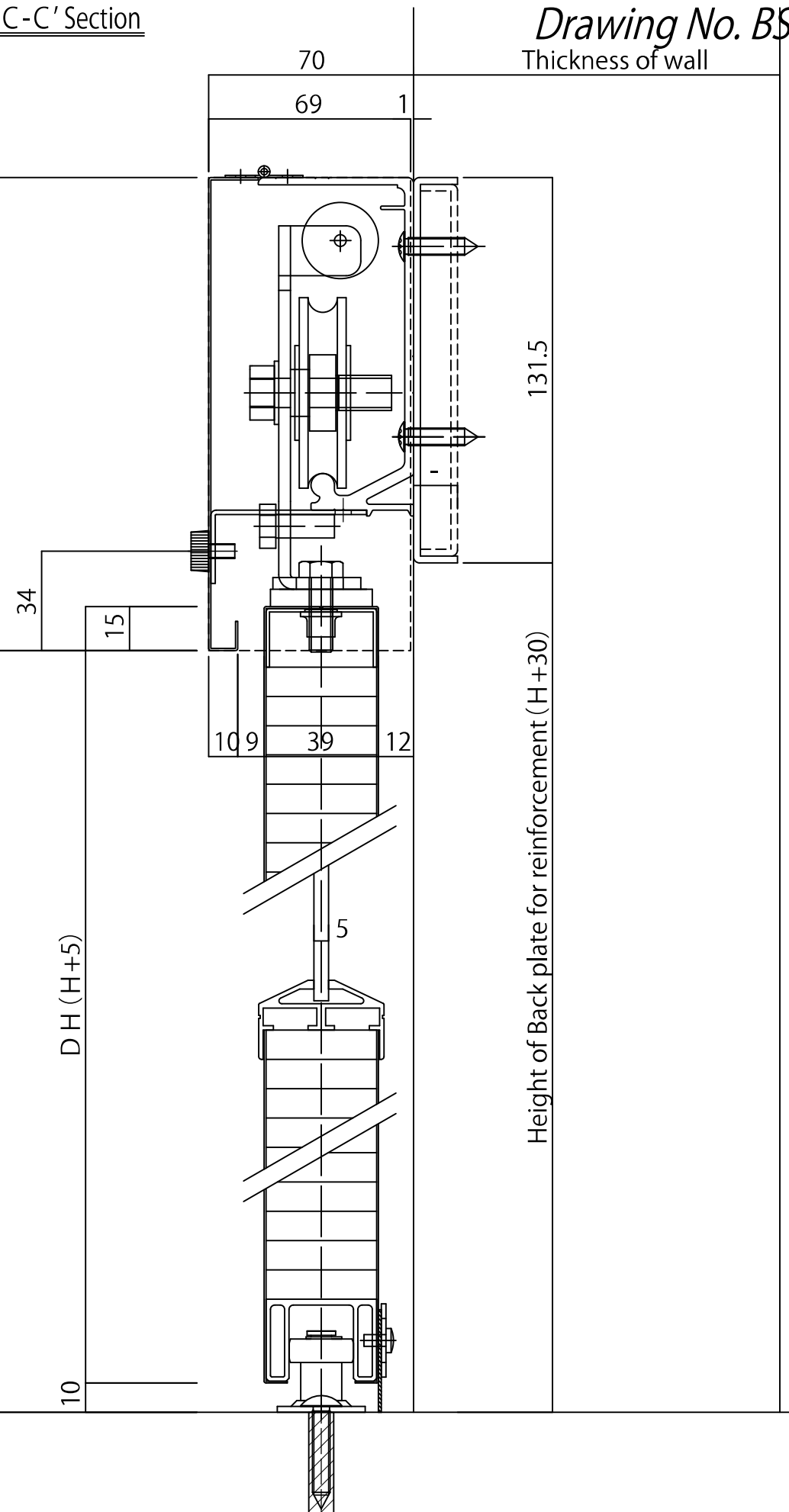

-	o	-	-	-	-				Drawing Name	UNIFLOW SLIDE DOOR SAT(Left) vertical section	株式会社 ユニフロー	-	-	-	Scale	-							
o	o															Drawing No.	-						
o	o															Date	- o - o -						
o	o																						
o	o																						

Width of door (D W)	Width of window	Height of window
$876 \leq DW < 940$	3 4 0	6 4 0
$940 \leq DW < 1240$	6 4 0	
$1240 \leq DW \leq 1676$	9 4 0	

Width of window	Height of window
2 0 0	7 0 0

	Single door	Double door
Effective Opening width (AW)	$700 \leq AW \leq 1500$	$1400 \leq AW \leq 3000$
Opening height (H)	$1800 \leq H \leq 2500$	

10	Opening frame	-	
9	Gasket	E P D M	-
8	Guide roller	Stainless•Polyacetal	-
7	Door head rubber cushion	PVC extruded (PVC resin)	-
6	Grip	Stainless	25φ L=450
5	Rail cover	Colored steel plate	t=0.8mm color:Ivory
4	Rail	Unit of automatic closing system, etc	-
3	Window frame	Aluminum alloy extruded material	color:almitte silver
2	Window	Acrylic plate	t=5.0mm color:Transparent
1	Suface material	Colored steel plate	t=0.6mm color:Ivory
No.	Name	Material	Remark

This architectural drawing illustrates a window assembly with various dimensions and components. The drawing includes the following details:

- Top Dimensions:**
 - Length of rail cover ($2W + 10$)
 - Length of rail ($2W - 10$)
 - Dimensions 10 and 10 at the top corners.
- Window Components:**
 - Two window units, each with a frame (3) and a sash (2).
 - Window frame width labeled as 7.
 - Window frame height labeled as 640.
 - Window frame depth labeled as 60.
 - Window frame material labeled as P425.
 - Window frame height labeled as 1000.
 - Window frame width labeled as 1000.
 - Window frame height labeled as 1100.
 - Window frame width labeled as 10.
- Dimensions and Spacing:**
 - Width of window
 - Dimensions 15, 10, and 161.5 on the right side.
 - Dimensions 10, 10, and 10 on the left side.
 - Dimensions 10, 10, and 10 on the bottom side.
 - Dimensions 10, 10, and 10 on the top side.
 - Dimensions 10, 10, and 10 on the right side.
 - Dimensions 10, 10, and 10 on the left side.
 - Dimensions 10, 10, and 10 on the bottom side.
 - Dimensions 10, 10, and 10 on the top side.
- Labels and Notes:**
 - Remaining 110 Overlap 50
 - Effective opening width (AW)
 - W
 - DW
 - Remaining 110 Overlap 50
 - FL ± 0
 - Width of window
 - Length of rail cover ($2W + 10$)
 - Length of rail ($2W - 10$)
 - Dimensions 10 and 10 at the top corners.
 - Dimensions 10, 10, and 10 on the right side.
 - Dimensions 10, 10, and 10 on the left side.
 - Dimensions 10, 10, and 10 on the bottom side.
 - Dimensions 10, 10, and 10 on the top side.

[illegible][illegible]

Drawing No. BSDWD01100



-	o	-	-	-
o	o			
o	o			
o	o			
o	o			

Scale
1/2
／

Drawing Name	#式名称	-	-	-	Date
UNIFLOW SLIDE DOOR SAT(double door) Horizontal cross section	J-SC-L	-	-	-	- o - o -

19.11.20

B-B' Section

Back plate, St-2.3t, for reinforcement of rail installation
 L=length as the rail (prepared by customers)

70
 69 1

Thickness of wall

Truss tapping screw

65

73

46

10

30

34

15

109

39

2

5

Width of frame

3

3-sided-frame
 Steel-1.6t Anticorrosive

5

Aluminum, 1.6t

Plate rubber (black), 0.5t

10

15

Screw anchor 8-35

$\nabla FL \pm 0$

161.5

H

DH(H+5)

C-C' Section

Drawing No. BSDWT01100

Thickness of wall

70

69 1

101.3

34

15

10

9

39

12

5

131.5

Height of Back plate for reinforcement (H+30)

DH (H+5)

101.3

34

15

10

9

39

12

5

131.5

Height of Back plate for reinforcement (H+30)

DH (H+5)

[illegible]