

Back plate, AL-2.0t for reinforcement of rail installation  
AL-2.0t L=Length of rail  
(prepared by customers)

Length of rail cover (2W+32)  
Length of rail (2W+12)

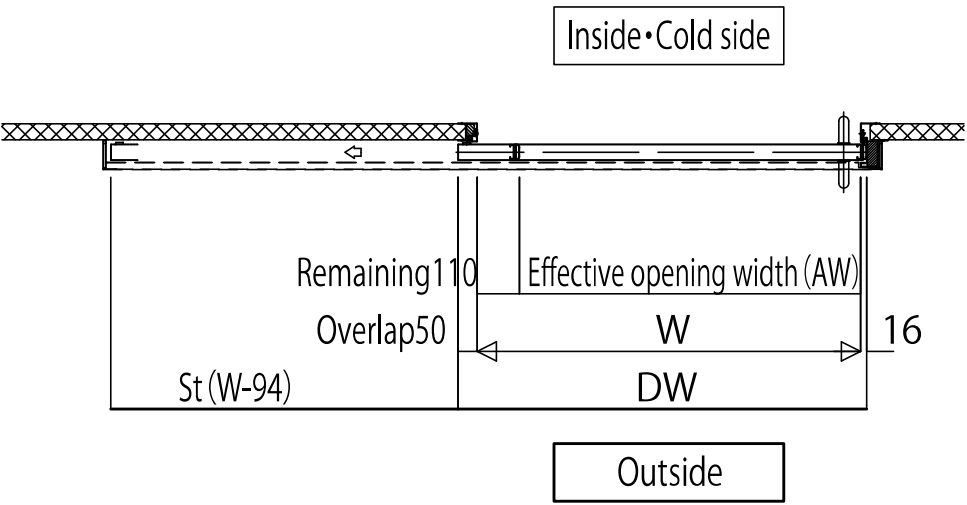
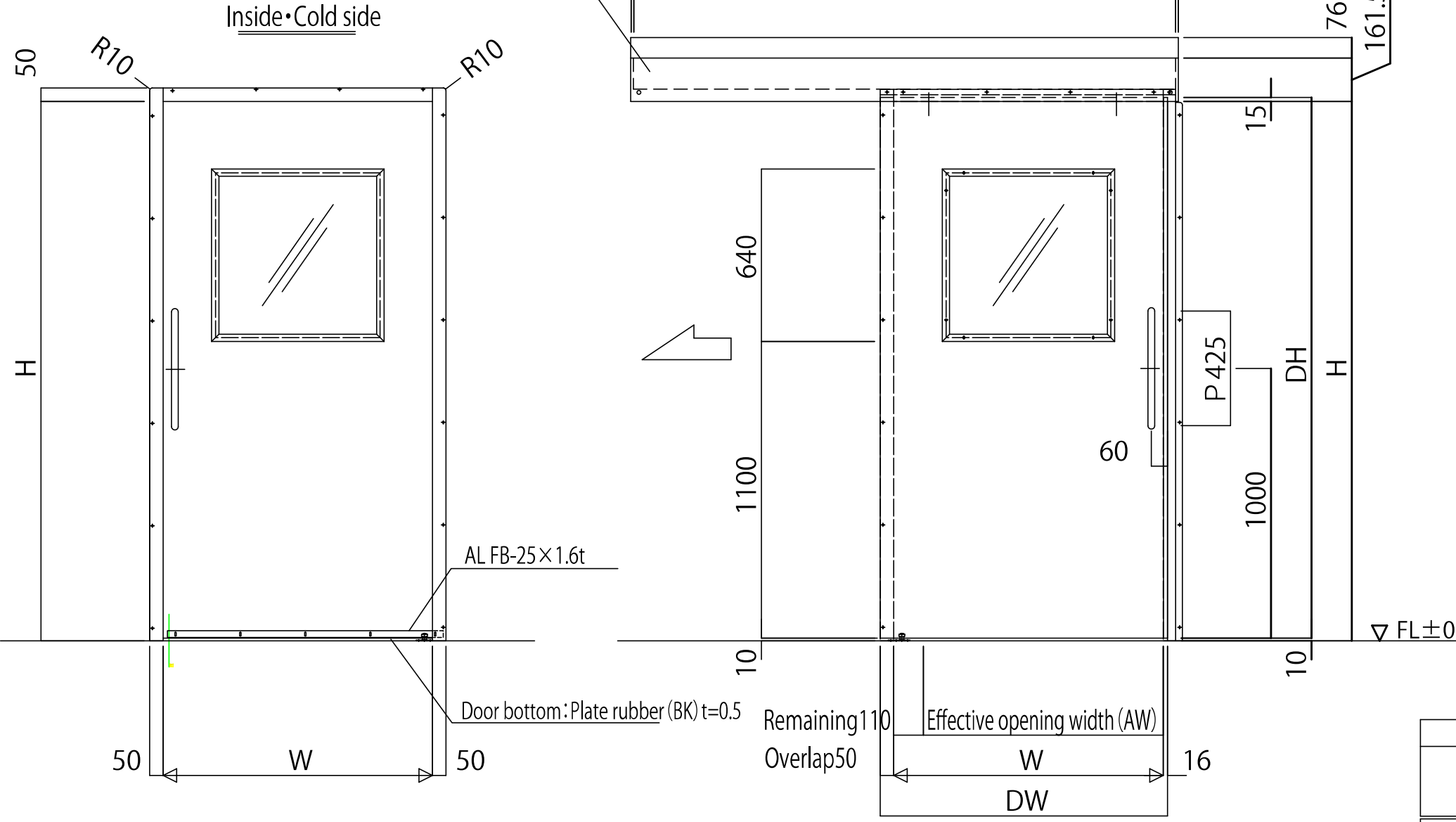

Window size (Outer dimensions)

Width of door (D W)	Width of window	Height of window
$776 \leq DW < 940$	340	640
$940 \leq DW < 1240$	640	
$1240 \leq DW \leq 1676$	940	

Note:The DW(with of door) in this table is based on cases when the overlap dimensions are standard.

Long window (outer dimension)

Width of window	Height of window
200	700

\*Lateral location of window installation is set in the center of the opening width (W)

\*Minimum dimensions of windows and louvers: W150 mm x up to H150 mm

\*Area for window installation: The following clearances are necessary:  
120 mm or more from the left or right side of a door  
150 mm or more from the door head or door bottom

\*Maximum window dimensions: Within the area for window installation and not more than 50% of the area of the door (excluding the case when the door is made of glass)

Possible dimentions for production

Effective opening width (A W)	Opening height (H)
$600 \leq AW \leq 1500$	$1800 \leq H \leq 2500$

\* When the DW exceeds the following dimensions, two sheets of the surface material are vertically joined (but, when the height is more than 2300 mm, this does not apply. Please feel free to consult us.

SUS No.4 (Standard) : DW>1165  
Colored steel plate (Optional) : DW>1336  
SECC (Optional) : DW>1471

\*When the non-pulled distance is equal to [0], the window is installed within the covering dimension of [80] and within 40 (core) from the guide roller frame.

\*When installing locks (MIWA FG lock):  
If you need an unopened distance of less than the standard size, please feel free to consult us.

\*Double doors cannot be manufactured.

\*Install the rail with the opposite side facing the cold side. If not installed correctly, the condensation reduction performance will not be achieved.

Code	Volume	Where to install	
	1	~	
Type		UNIFLOW SLIDE DOOR SAT-nc (Condensation reduction specifications)	
Door	Surface material	Stainless steel 0.8t No.4	
	Core of the door	Polystyrene foam	
Frame	Stainless steel1.5t HL		Door sill Y • (N)
Name	Material	Remark	
Door hook	-	-	-
Grip	Our specifications (SUS)	φ25 L=450	1
Rail	Unit of automatic closing system,etc	-	1式
Rail cover	Stainless steel 0.8t	No.4	1
Guide roller	Our specifications	SUS Adjustable	1
Door head rubber cushion	Our specifications	PVC	1
Window frame	Al alloy extruded material	color:almitte silver	1
Window	Double glazed acrylic (5t+10+5t)	color:Transparent	1
Gasket	EPDM	Installed on 3-sided-frame	1

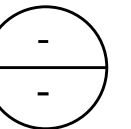

Inside • Cold side

[illegible]

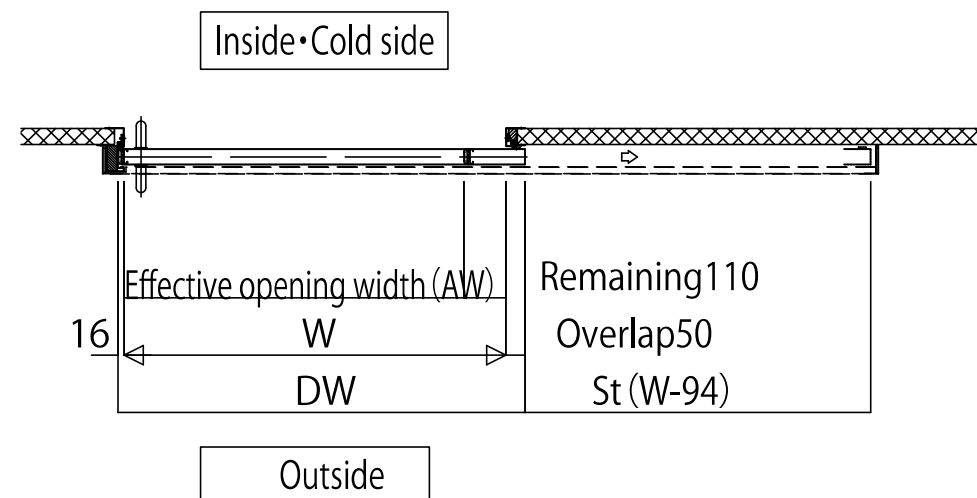
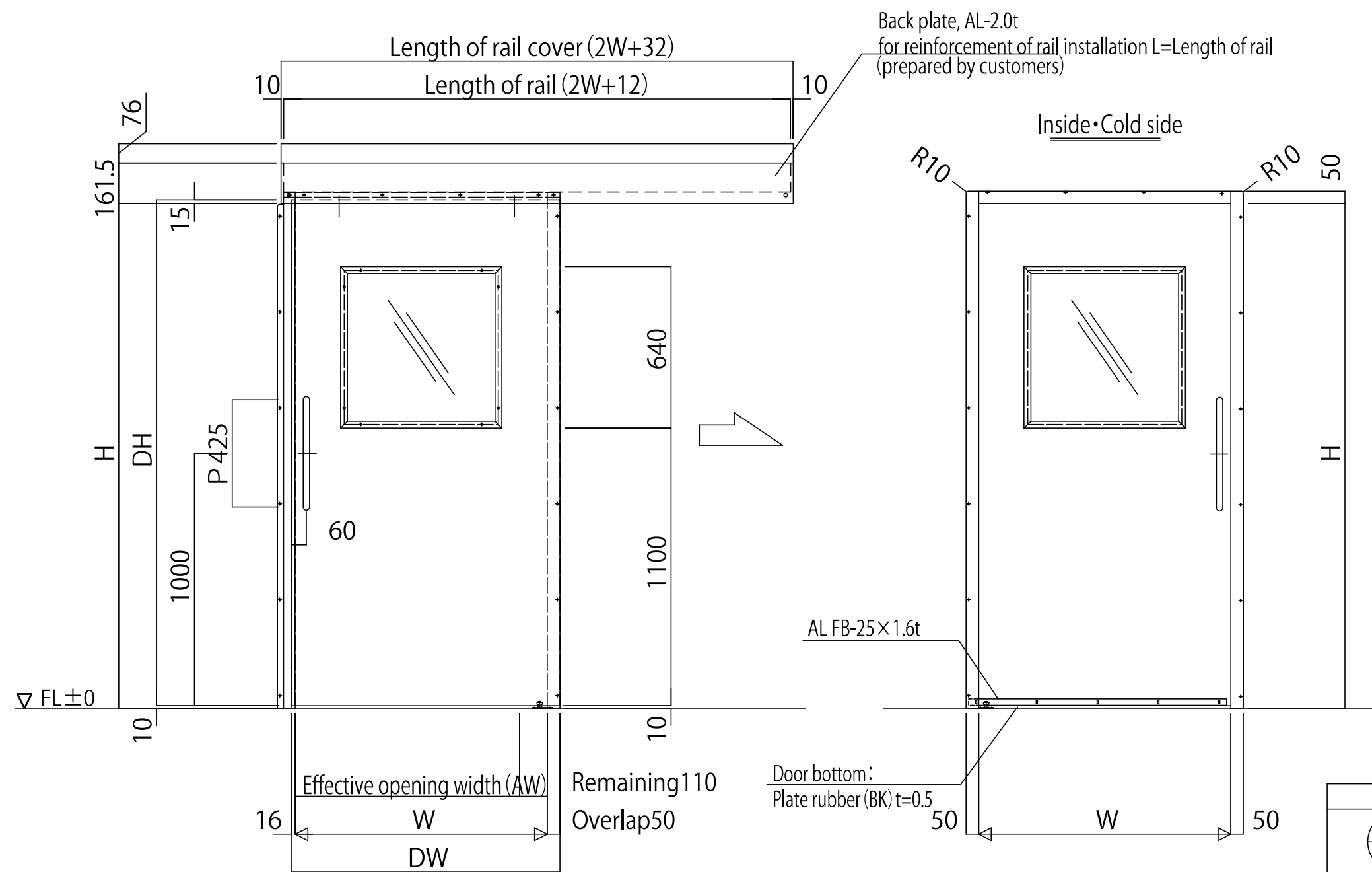

*Window size (Outer dimensions)*

Width of door (D W)	Width of window	Height of window
$776 \leq DW < 940$	3 4 0	6 4 0
$940 \leq DW < 1240$	6 4 0	
$1240 \leq DW \leq 1676$	9 4 0	

Note: The DW (with of door) in this table is based on cases when the overlap dimensions are standard.

*Long window (outer dimension)*

Width of window	Height of window
200	700

\*Lateral location of window installation is set in the center of the opening width (W)

\*Minimum dimensions of windows and louvers: W150 mm x up to H150 mm

\*Area for window installation: The following clearances are necessary:  
120 mm or more from the left or right side of a door  
150 mm or more from the door head or door bottom

\*Maximum window dimensions: Within the area for window installation and not more than 50% of the area of the door (excluding the case when the door is made of glass)

### Possible dimentions for production

	Single door
Effective opening width (A W)	$600 \leq AW \leq 1500$
Opening height (H)	$1800 \leq H \leq 2500$

\* When the DW exceeds the following dimensions, two sheets of the surface material are vertically joined (but, when the height is more than 2300 mm, this does not apply. Please feel free to consult us.

SUS No.4 (Standard) : D W>1165  
Colored steel plate (Optional) : D W>1336  
SECC (Optional) : D W>1471

\*When the non-pulled distance is equal to [0], the window is installed within the covering dimension of [80] and within 40 (core) from the guide roller frame.

\*When installing locks (MIWA FG lock):  
If you need an unopened distance of less than the standard size, please feel free to consult us.

\*Double doors cannot be manufactured.

\*Install the rail with the opposite side facing the cold side. If not installed correctly, the condensation reduction performance will not be achieved.

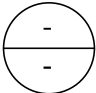
Code	Volume	Where to install	
	1	~	
Type	UNIFLOW SLIDE DOOR SAT-nc (Condensation reduction specifications)		
Door	Surface material	Stainless steel 0.8t No.4	
	Core of the door	Polystyrene foam	
Frame	Stainless steel 1.5t HL	Door sill Y • (N)	
Name	Material	Remark	
Door hook	-	-	-
Grip	Our specifications (SUS)	φ25 L=450	1
Rail	Unit of automatic closing system, etc	-	1式
Rail cover	Stainless steel 0.8t	No.4	1
Guide roller	Our specifications	SUS Adjustable	1
Door head rubber cushion	Our specifications	PVC	1
Window frame	Al alloy extruded material	color: almite silver	1
Window	Double glazed acrylic (5t+10+5t)	color: Transparent	1
Gasket	EPDM	Installed on 3-sided-frame	1

[illegible]



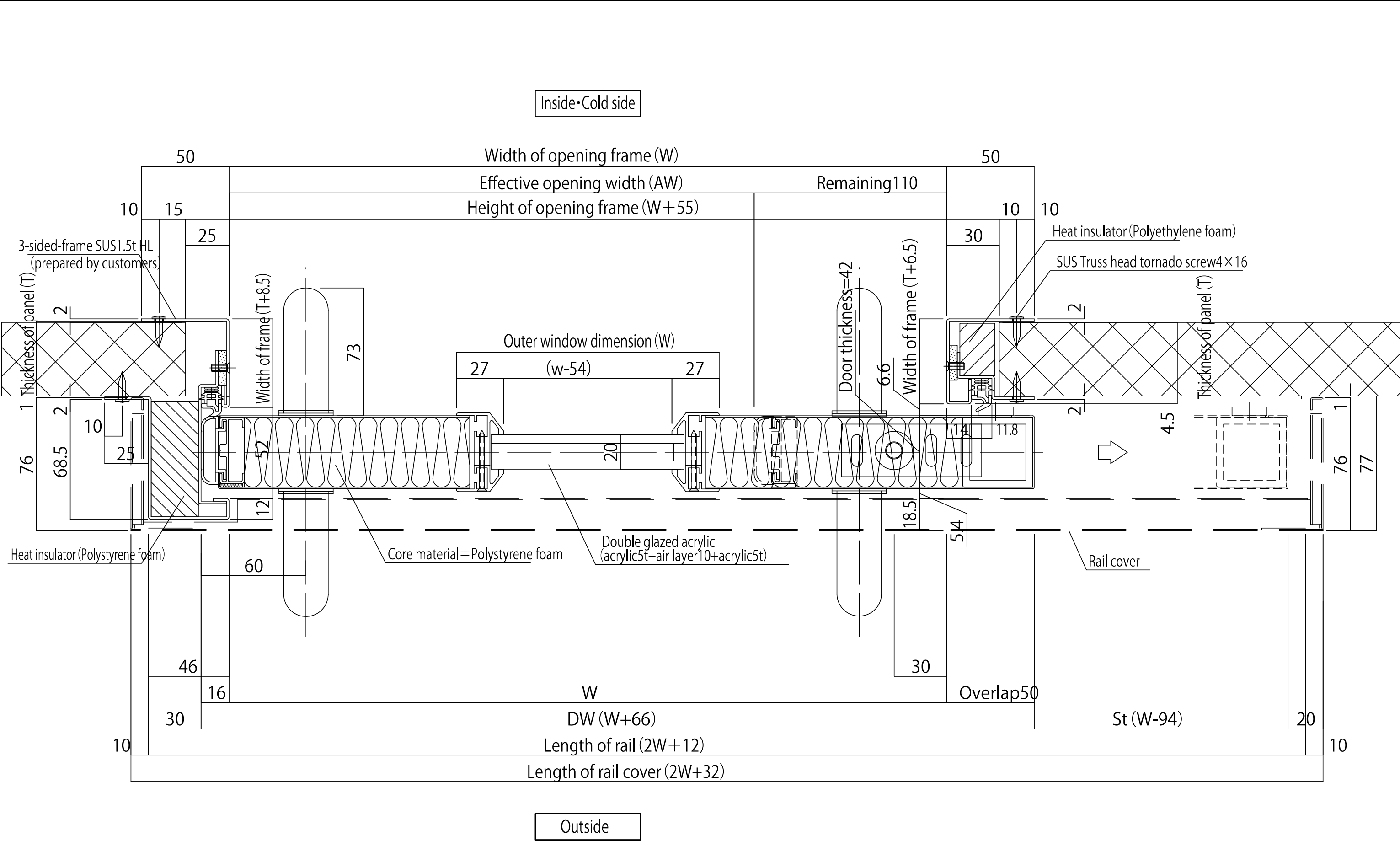

-	•	-	•	-	-								Scale	-						
•	•													1/2	Drawing No.	-				
•	•													/	Date	-	•	-	•	-
•	•																			
•	•																			
						Drawing name														
						UNIFLOW SLIDE DOOR														
						SAT-nc (Right)														
						Horizontal cross section														