

Range of manufacturing

	Single leave	Double leave
Opening width (W)	400 ≤ W ≤ 1200	800 ≤ W ≤ 2400
Opening height (H)	800 ≤ H ≤ 2400	

No.	Name	Material	Remark
1	Surface material	Bonde steel plate	thickness 0.8 mm
2	Window	Acrylic resin hard coat	color: clear/thickness of acrylic 10 mm
3	A door head side buffer	PVC	color: grey
4	Pipe for front door	Aluminum	color: alumite silver
5	A door tail side buffer	PVC	color: grey
6	Upper hingi	Steel	Unichrome plating
7	Hinge of below door	Stainless steel	thickness 0.4 mm
8	Hinge of below frame side	Stainless steel	thickness 0.4 mm
9	Screw for bracket in frame side	Stainless steel (304)	+A flathead tapping 6x30, with PYplug 8x32
10	Cap for pipe of front door side	Elastomer	color: grey
11	Vertical frame (Prepared by Uniflow)	Bonde steel plate 1.6mm	Width of opening frame for door installation (105~175)
12	Upper frame (Prepared by Uniflow)	Bonde steel plate 1.6mm	Width of opening frame for door installation (110~180)

is shown for a door head side • tail side buffer PVC

Core of door: paper core

※ Opening frame for door installation (3-sided-frame) (Vertical frame upper frame) :

Finished: Rust preventive painting is typical.

Option will be baking painting. In this case, please give information of baking painting No.

Back-plate for fixing bracket should be set for reinforcement (prepared by Uniflow)

Sign	Quantity	Installation place
	1	~
Type	UNIFLOW SMART SWING DOOR Model: SMT Single leave	
Accessory	Quantity	Model

Revision	Project Title	Drawing Name	Saled by	Checked by	Drawn by	Scale	Reference No
- - - - -	Smart Swing Door model SMT	SMART SWING DOOR Model: SMT 《 Installation view 》	-	-	-	1/2	Page No 01
• • • • •							Date - - - - -
• • • • •							
• • • • •							



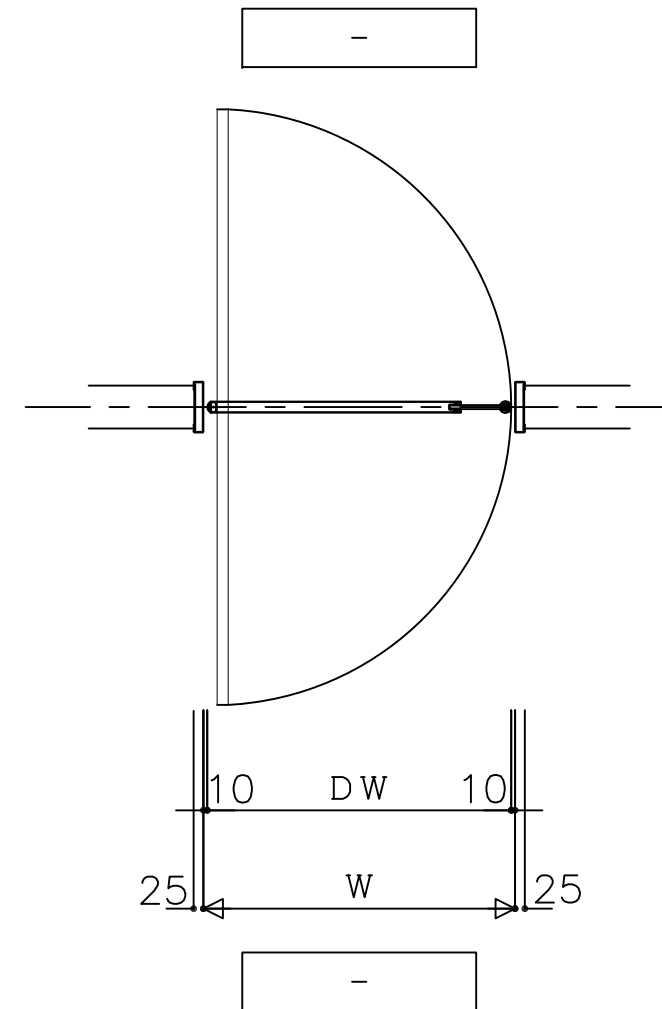
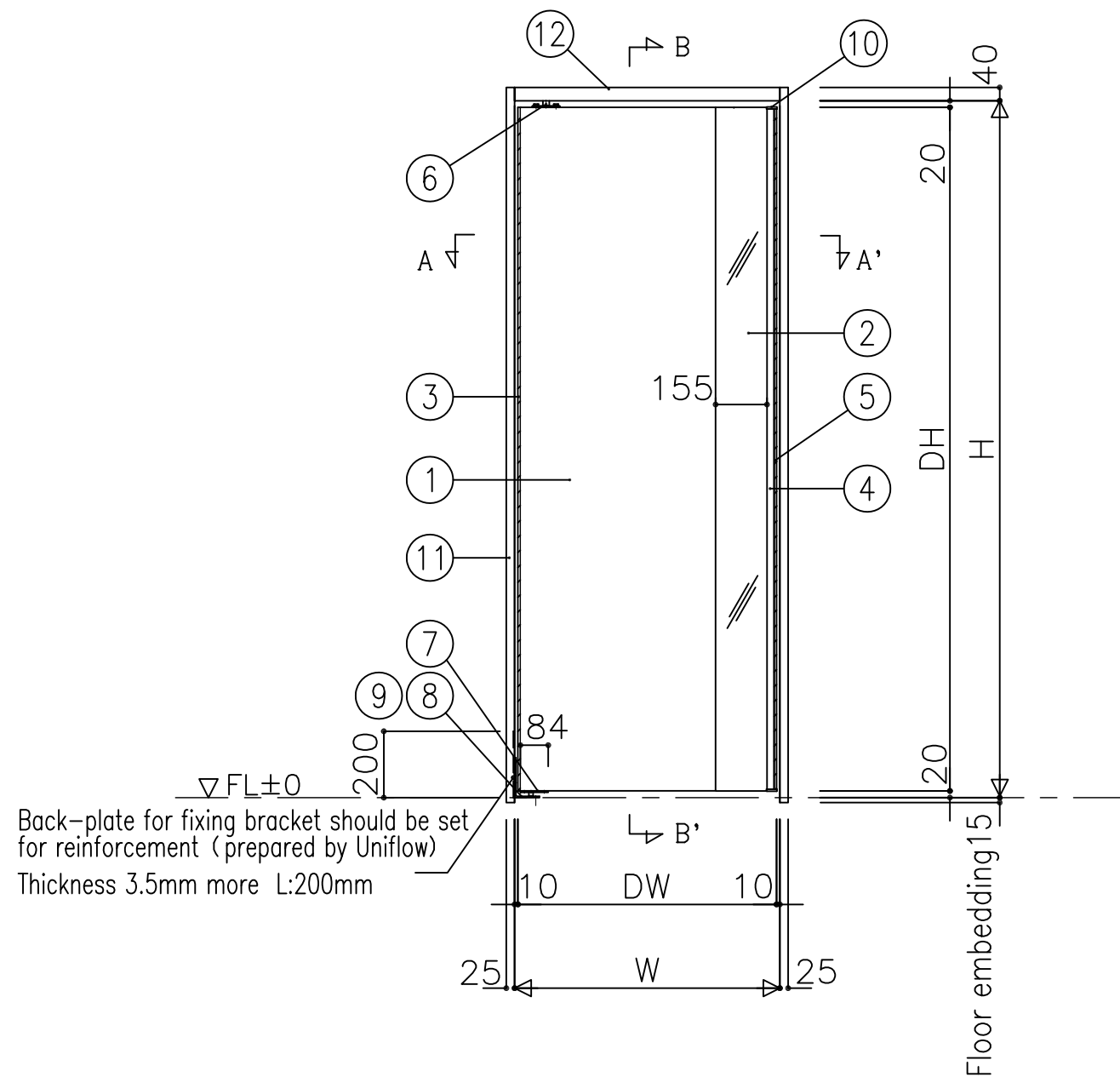

Range of manufacturing

	Single leave	Double leave
Opening width (W)	400 ≤ W ≤ 1200	800 ≤ W ≤ 2400
Opening height (H)	800 ≤ H ≤ 2400	

No.	Name	Material	Remark
1	Surface material	Bonde steel plate	thickness 0.8 mm
2	Window	Acrylic resin hard coat	color: clear/thickness of acrylic 10 mm
3	A door head side buffer	PVC	color: grey
4	Pipe for front door	Aluminum	color: alumite silver
5	A door tail side buffer	PVC	color: grey
6	Upper hinge	Steel	Unichrome plating
7	Hinge of below door	Stainless steel	thickness 0.4 mm
8	Hinge of below frame side	Stainless steel	thickness 0.4 mm
9	Screw for bracket in frame side	Stainless steel (304)	+A flathead tapping 6x30, with PYplug 8x32
10	Cap for pipe of front door side	Elastomer	color: grey
11	Vertical frame (Prepared by Uniflow)	Bonde steel plate 1.6mm	Width of opening frame for door installation (105~175)
12	Upper frame (Prepared by Uniflow)	Bonde steel plate 1.6mm	Width of opening frame for door installation (110~180)

is shown for a door head side・tail side buffer PVC

Core of door: paper core

※ Opening frame for door installation (3-sided-frame) (Vertical frame upper frame) :

Finished: Rust preventive painting is typical.

Option will be baking painting. In this case, please give information of baking painting No.

Back-plate for fixing bracket should be set for reinforcement (prepared by Uniflow)

Sign	Quantity	Installation place
	1	~
Type	UNIFLOW SMART SWING DOOR Model: SMT Single leave	
Accessory	Quantity	Model

Revision	Project Title	Drawing Name	Saled by	Checked by	Drawn by	Scale	Reference No
- - - - -	Smart Swing Door model SMT	SMART SWING DOOR Model: SMT 《Installation view》	-	-	-	1/2	Page No 03
o o o o o							Date - - - - -
o o o o o							
o o o o o							
o o o o o							

UNIFLOW

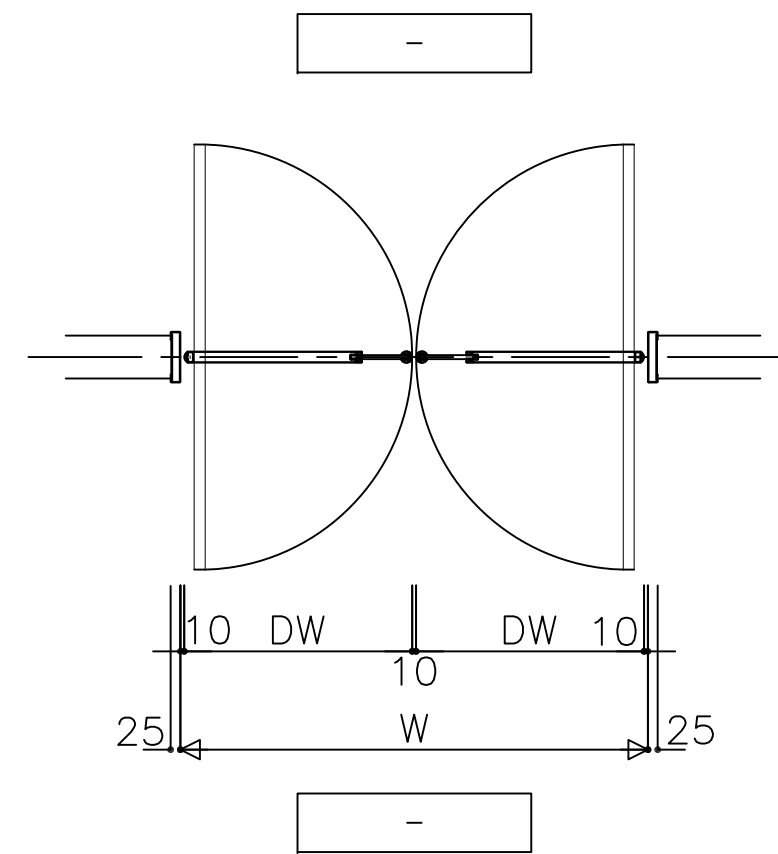
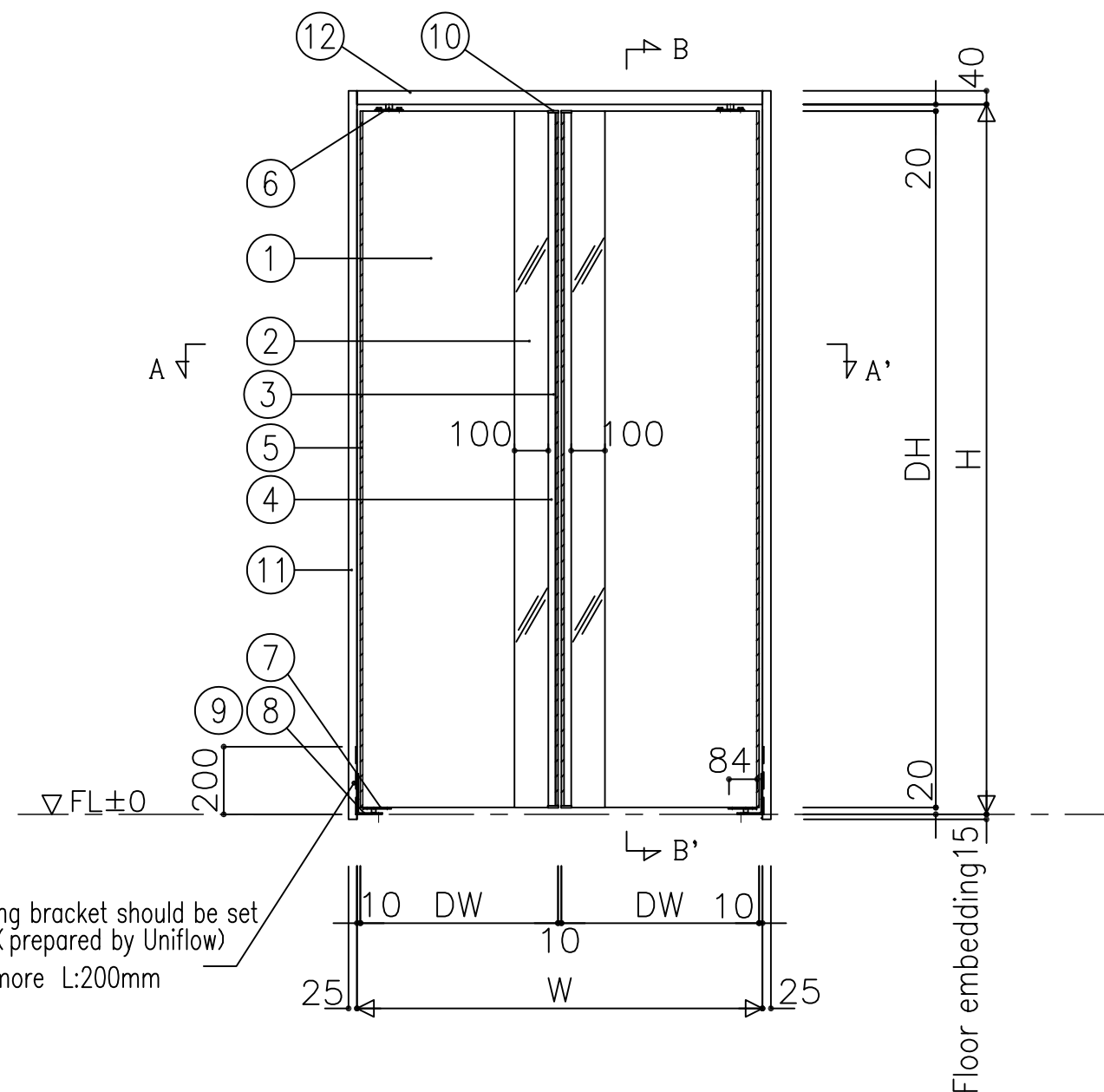

Range of manufacturing

	Single leaf	Double leaf
Opening width (W)	400 ≤ W ≤ 1200	800 ≤ W ≤ 2400
Opening height (H)	800 ≤ H ≤ 2400	

No.	Name	Material	Remark
1	Surface material	Bonde steel plate	thickness 0.8 mm
2	Window	Acrylic resin hard coat	color: clear/thickness of acrylic 10 mm
3	A door head side buffer	PVC	color: grey
4	Pipe for front door	Aluminum	color: alumite silver
5	A door tail side buffer	PVC	color: grey
6	Upper hinge	Steel	Unichrome plating
7	Hinge of below door	Stainless steel	thickness 0.4 mm
8	Hinge of below frame side	Stainless steel	thickness 0.4 mm
9	Screw for bracket in frame side	Stainless steel (304)	+A flathead tapping 6x30, with PYplug 8x32
10	Cap for pipe of front door side	Elastomer	color: grey
11	Vertical frame (Prepared by Uniflow)	Bonde steel plate 1.6mm	Width of opening frame for door installation (105~175)
12	Upper frame (Prepared by Uniflow)	Bonde steel plate 1.6mm	Width of opening frame for door installation (110~180)

is shown for a door head side・tail side buffer PVC

Core of door: paper core

※ Opening frame for door installation (3-sided-frame) (Vertical frame upper frame) :

Finished: Rust preventive painting is typical.

Option will be baking painting. In this case, please give information of baking painting No.

Back-plate for fixing bracket should be set for reinforcement (prepared by Uniflow)

Sign	Quantity	Installation place
	1	~
Type	UNIFLOW SMART SWING DOOR Model: SMT Double leaves	
Accessory	Quantity	Model

Revision	Project Title	Drawing Name	Saled by	Checked by	Drawn by	Scale	Reference No
- - - - -	Smart Swing Door model SMT	SMART SWING DOOR Model: SMT 《Installation view》	-	-	-	1/2	Page No 05
○ ○ ○ ○ ○						/	Date - - - - -



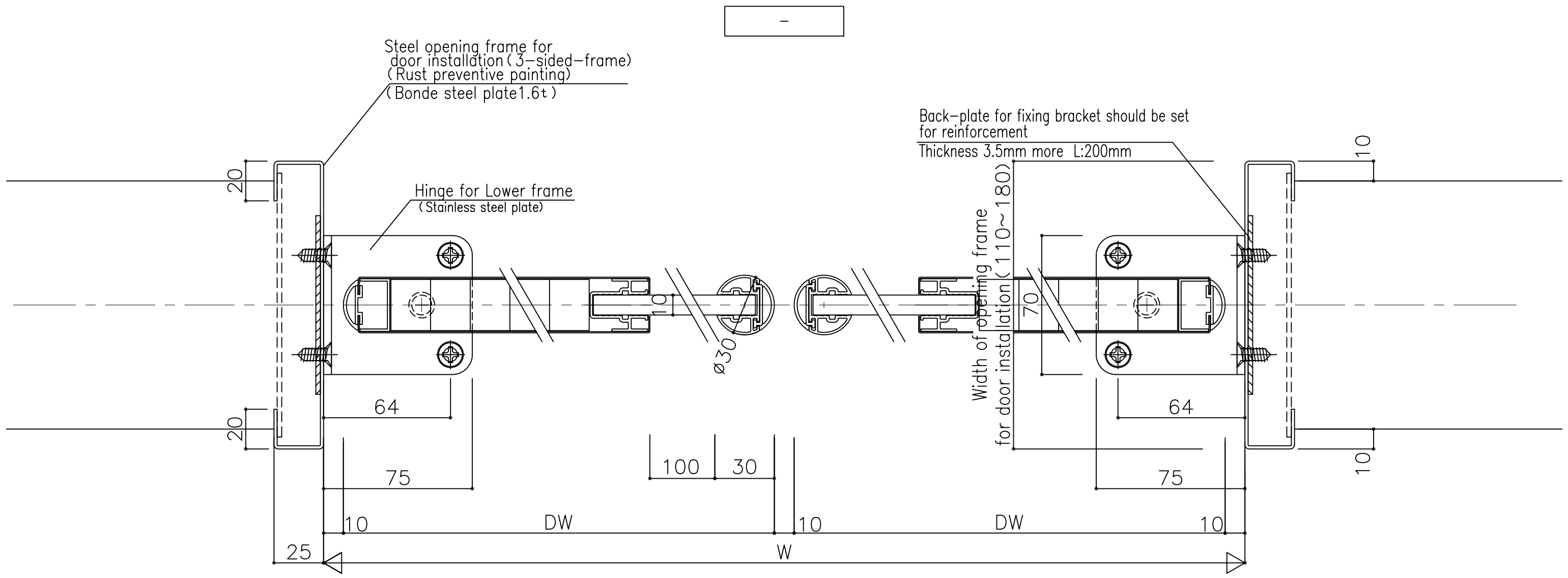

Revision	-

Project Title
Smart Swing Door model SMT

Drawing Name
SMART SWING DOOR
Model: SMT
《Horizontal cross section》



Saled by -
Checked by -
Drawn by -

Scale 1/2
Reference No
Page No 06
Date - . - . -

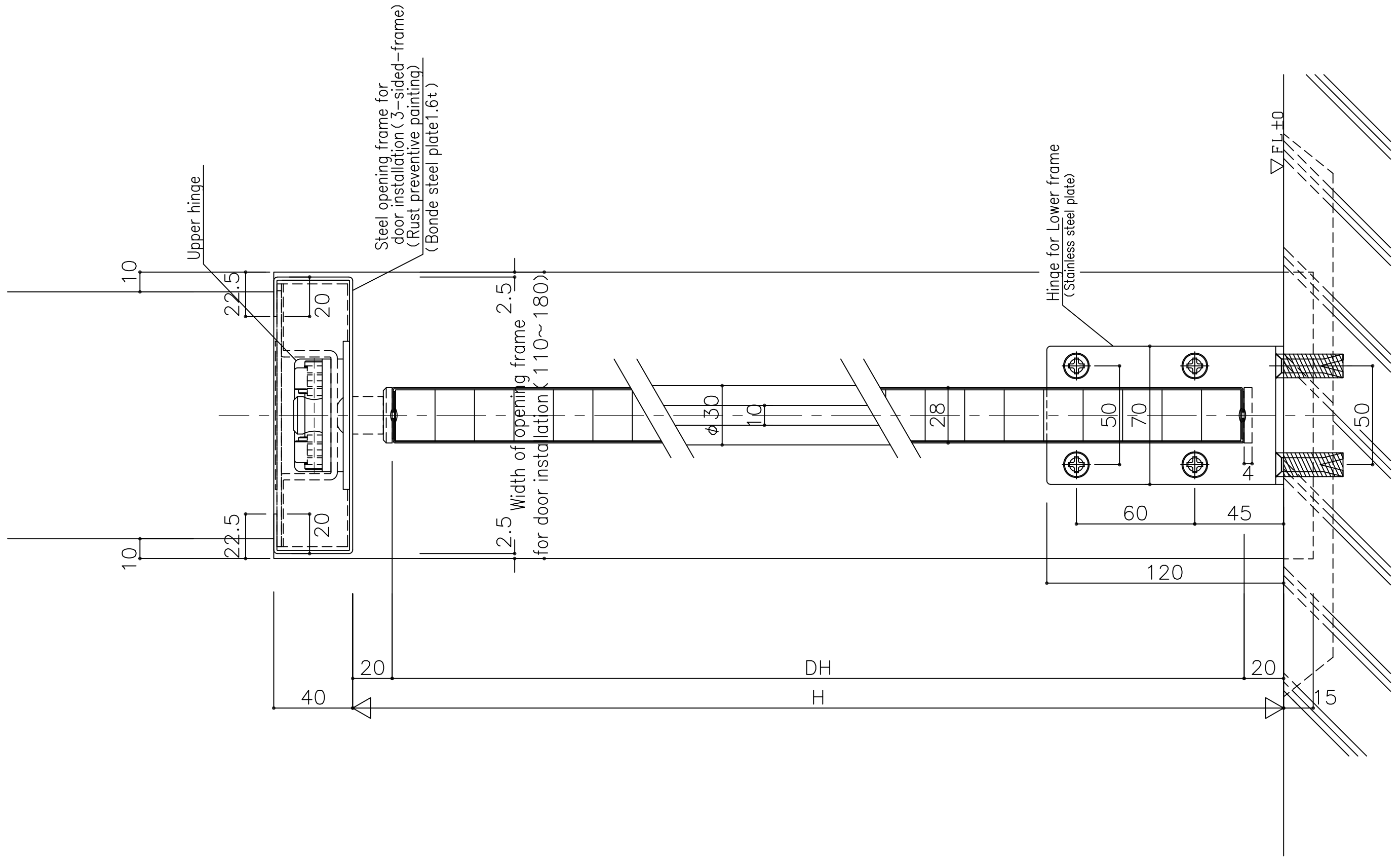

Revision	
-	○ ○ ○ -
○	○ ○ ○
○	○ ○ ○
○	○ ○ ○
○	○ ○ ○

Project Title
Smart Swing Door model SMT

Drawing Name
SMART SWING DOOR
Model: SMT
《Vertical cross section》



Saled by -
Checked by -
Drawn by -

Scale 1/2
Reference No Page No 07
Date - ○ - ○ -